

de Souther
MEDICAL

Powered Instruments for large bone surgery



featuring the new
EcoPulse™



powered instruments for large bone surgery

CONTENTS

MultiDrive™ system

Modular handpiece attachments 3

Electric powered

MDX MultiDrive™ battery and corded handpieces 5

Procedure specific battery and corded handpieces 6

Battery options 7

Battery charger and corded direct power 8

Air powered

MPX MultiDrive™ air powered handpieces 9

Procedure specific air powered handpieces 10

PLX EcoPulse™ Pulsed irrigation system 11

Ancilliary equipment

Sterilisation containers 12

Accessories 13

All products in this catalogue are backed by the De Soutter Medical no nonsense warranty.
All instruments shown in this catalogue are CE marked.

The technologically advanced De Soutter Medical large bone surgical system sets new standards for orthopaedic power tools. Enjoy the versatility of real power, compactness and lightness with a comprehensive range of quick change attachments. Be it large bone or trauma, the De Soutter Medical large bone system covers them both with precision, performance and reliability.

The versatile large bone system



MODULAR SYSTEM

30 attachments with proven, quick change locking mechanism. See page 3.

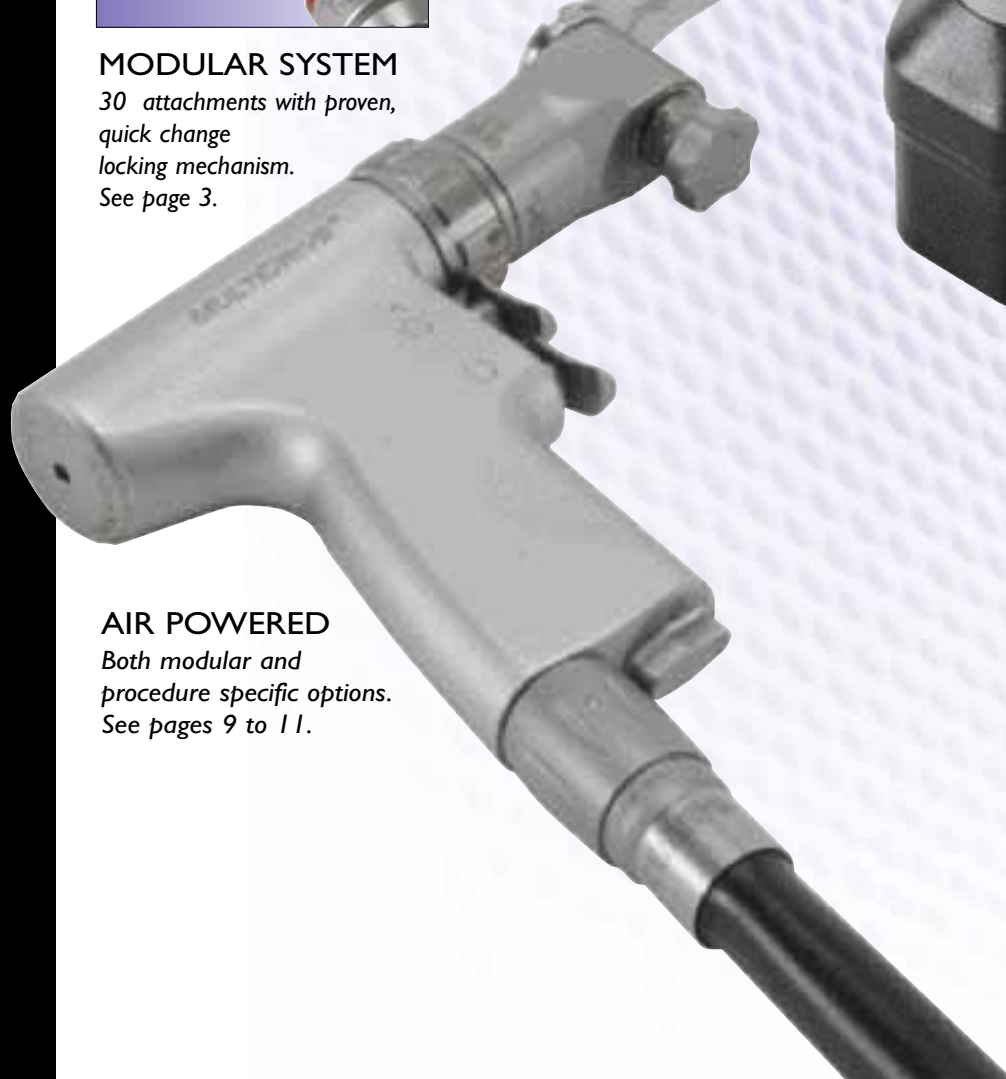

AIR POWERED

Both modular and procedure specific options. See pages 9 to 11.

BATTERY AND CORDED

Both modular and procedure specific options with battery, aseptic battery and corded direct power.

See pages 5 to 8.

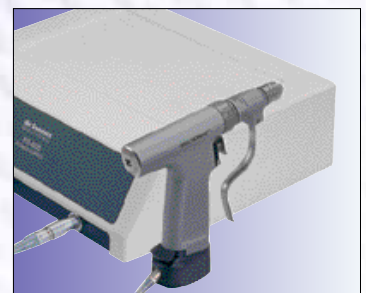

MultiDrive™ System

Modular handpiece and attachment system



MDX-610

Battery or corded handpiece options. See pages 5 - 8.



MPX-610

Air powered handpiece. See page 9.

	Order code	Chuck Description	Type	Speed rpm/cpm	Cannulation mm
Drilling attachments					
	11710	0 - 6.35 mm (1/4") Jacobs	DX-600	0 - 950	4.1
	11720	0 - 4 mm (5/32") Jacobs	DX-600	0 - 950	3.1
	11860	Hi-torque - 0 - 6.35 mm (1/4") Jacobs	DX-600	0 - 500	4.1
	11740	0 - 3.2 mm (1/8") keyless	DX-600	0 - 950	2.4
	11750	0.8 - 6.35 mm (1/4") keyless	DX-600	0 - 950	4.1
Quick release drilling attachments					
	11730	A.O. Synthes™/ASIF	DX-600	0 - 950	2.0
	11780	A.O. Synthes™/ASIF Hex	DX-600	0 - 950	2.0
	11770	Hudson	DX-600	0 - 950	4.1
	11790	Trinkle	DX-600	0 - 950	4.1
	12420	Zimmer	DX-600	0 - 950	4.1
	14480	Hudson/Zimmer combi	DX-600	0 - 950	4.1
	11760	Oscillating drill - 130° oscillation arc	OX-600	0 - 950	-
See page 14 for range of drill bits See Accessory catalogue No. 162 for range of taps.					
Standard reaming attachments					
	11800	0 - 6.35 mm (1/4") Jacobs	RX-600	0 - 260	4.1
	11810	Hudson	RX-600	0 - 260	4.1
	11820	A.O. Synthes™/ASIF/PROTEK	RX-600	0 - 260	4.1
	11830	Zimmer	RX-600	0 - 260	4.1
	12900	Hudson/Zimmer combi	RX-600	0 - 260	4.1
Hi-torque reaming attachments					
	11850	Hudson/Zimmer combi	HX-600	0 - 150	-
	11840	A.O. Synthes™/ASIF/PROTEK	HX-600	0 - 150	-
See page 13 for acetabular reamer shafts and shells					
Sawing attachments for MPX-610 only					
	12390	Reciprocating saw Uses S22 type blades	CX-600	0 - 9000	
	12380	Large sagittal saw Uses S87 type blades	KX-600	0 - 13000	
	14400	Mini sagittal saw Uses S83 type blades	MX-600	0 - 12000	
Sawing attachment for MDX-610 only					
	12600	Reciprocating saw Uses S22 type blades	CX-650	0 - 7500	
Sawing attachments for both MPX-610 and MDX-610					
	12300	Mini sagittal saw Uses S88 type blades	NX-600	0 - 25000	

See page 13 for other chuck drive options.

Order code	Final drive	Type	Speed rpm
------------	-------------	------	-----------

Minimal invasive acetabular reamer attachment

12100	Accepts De Soutter acetabular reamer shells	MI-600	0 - 150
-------	---	--------	---------

See page 13 for range of acetabular reamer shells



Minimal invasive acetabular reamer attachment

14990	Hudson drive	MI-610	0 - 150
15180	A.O. drive	MI-610	0 - 150

See page 13 for range of acetabular reamer shells



Radiolucent drill adaptor

11980	Accepts A.O. radiolucent drill attachment	TX-600	0 - 950
-------	---	--------	---------



Pulse Lavage attachment

15820	Accepts P20 series pump kits	LX-620	0 - 1600 pulses/min.
-------	------------------------------	--------	----------------------

MPX and MDX handpieces can be connected direct to P20 pump kits. Pulse rate 950 pulses/min when used in this configuration.



P20-100 pump kit
See page 11 for range of pump Kits.

Wire/pin driving attachment

11930	0.7 - 3.2 mm capacity	WX-600	0 - 950
-------	-----------------------	--------	---------

See Stericut™ catalogue for wire and guides range.



MDX MultiDrive™

Modular and procedure specific - battery and



MDX-610 Hi-Torque
*fitted with
 A.O. quick release
 drill attachment and
 sterile battery.*

MDX-610 HANDPIECE SPECIFICATION

Order code	Speed	Cannulation	Voltage*
1286444	0 - 950 rpm	4.1 mm	9.6 Vdc



* Cordless 9.6 Vdc battery or corded direct from power supply module.
 See pages 7 and 8 for details of power options.
 See pages 3 and 4 for attachment range.
 See page 12 for sterilisation containers.

POWER OPTIONS



Small sterilisable battery



Large sterilisable battery



Small aseptic battery



Large aseptic battery



Corded system

- Superior handpiece reliability with high performance, hermetically sealed, hybrid motor controller.
- Single handed, instant forward, reverse and safe mode on MDX handpiece.
- 2 speed trigger function on saw handpieces.
- State of the art battery charging technology means batteries are charged to optimum capacity.
- Class leading power to weight ratio.

corded system



CDX-600
fitted with saw blade
and aseptic housing
carrying small
battery.

KDX-600
fitted with saw blade
and aseptic housing
carrying large battery.

HANDPIECE SPECIFICATION

Type	Type code	Order code	Speed	Voltage*
Sagittal saw	KDX-600	I282554	0 - 14000 cycles/min	9.6 Vdc
Reciprocating saw	CDX-600	I282664	0 - 9000 cycles/min	9.6 Vdc



* Cordless 9.6Vdc battery or corded direct from power supply module. See pages 7 and 8 for details of power options.
See Stericut™ catalogue for range of sagittal and reciprocating saw blades.
See page 12 for sterilisation containers.

Electric Power Options

Ultimate versatility with a choice of three po

STERILE BATTERY

The packs are specifically designed to withstand flash sterilisation techniques.

Extended autoclaving and drying cycles may reduce the capacity and life of the battery pack.

If flash sterilisation is not permissible (please check your market requirements) then the use of aseptic batteries is strongly recommended.

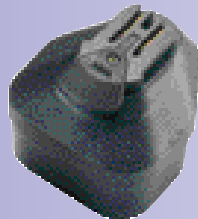

SB-600
9.6 Vdc NiCd
Capacity 1200 mAh
Battery Pack
Order Code 11630



SB-450
10.8 Vdc NiMH
Capacity 1000 mAh
Battery Pack
Order Code 14500

ASEPTIC BATTERY SYSTEMS

The simple aseptic battery technique ensures the packs are maintained and used in their optimal condition.

Battery management is readily supervised by the theatre staff as the battery charger can be safely placed within the OR.

Large Battery Pack

AB-600
9.6 Vdc NiMH battery
Capacity 2100 mAh
Order Code 11520

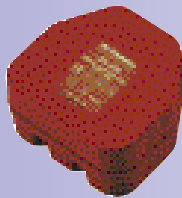

AH-610
Aseptic Housing
Order Code 14430



AS-610
Sterile Shield
Order Code 14420

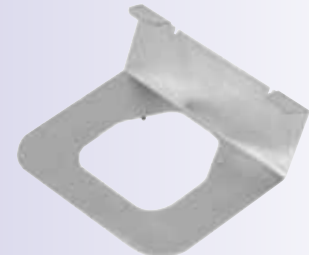

Small Battery Pack

AB-450
10.8 Vdc NiMH battery
Capacity 1000 mAh
Order Code 14510



AH-450
Aseptic Housing
Order Code 14520



AS-450
Sterile Shield
Order Code 14530

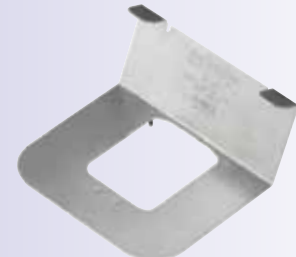

Loading and replacing the aseptic battery pack



Sterile scrub technician places sterile shield onto the aseptic battery housing.



Circulating nurse presses the non sterile battery into the battery housing.



Circulating nurse removes the sterile shield.

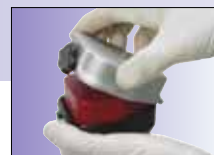

Sterile scrub technician closes battery housing lid and secures locking knob.



Sterile scrub technician locks aseptic battery housing into the handpiece.

Power options

BATTERY CHARGER BC-610

Order Code 14750

The BC-610 battery charger allows four batteries to be charged simultaneously.

The unit has a very small footprint and is designed to accept both sterile and aseptic batteries without the use of adaptors.

The charger is easy to operate and provides the user with instantaneous information on a battery's charge status.

A simple display panel allows the user to quickly establish the status of the charging cycle and the general condition of the battery by illuminating indicator bars when it has completed its charging cycle.

Once a battery pack is inserted into the charger it automatically carries out a full diagnostic check and selects the correct charging mode i.e. fast charge, trickle charge etc. The typical re-charging cycle for a used battery is 30 minutes.

Mains power cordsets - 3m long
 UK Order Code: 8290
 Euro Order Code: 8300
 US/Canada Order Code: 8310
 Australia/N Zealand Order Code: 8320
 Please specify option required.



CA-450
 Small battery charging adaptor.
 For use with AB-450 battery.
 Order Code 14540

CORDED DIRECT POWER

The compact, lightweight corded module simply slides into the bottom of the handpiece and is connected to the power supply via a small diameter flexible cable.

The power supply has two handpiece outlet connections and features an overload indicator which aids the surgeon in achieving optimum cutting performance.

CM-600
 Corded module 4m long.
 Order Code 11620



PS-600
 Power Supply 230 Vac input
 Order Code 11610

Power Supply 120 Vac input
 Order Code 11660

Mains power cordsets -
 3m long

UK Order Code: 8290
 Euro Order Code: 8300
 US/Canada Order Code: 8310
 Australia/N Zealand Order Code: 8320
 Please specify option required.

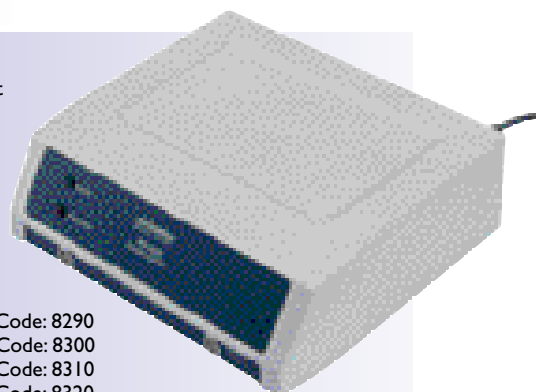

MPX MultiDrive™

Modular and procedure specific - air operate



MPX-610 Hi-Torque
fitted with
A.O. quick release
drill attachment.



Three position trigger
function control.
Forward, reverse and safe
operating mode.

MPX-610 HANDPIECE SPECIFICATION

Order code	Speed	Cannulation	Inlet connection	Operating pressure
226464	0 - 950 rpm	4.1 mm	MPX standard	6 - 7 bar
226474	0 - 950 rpm	4.1 mm	Zimmer	6 - 7 bar
226484	0 - 950 rpm	4.1 mm	Aesculap	6 - 7 bar
226494	0 - 950 rpm	4.1 mm	A.O.	6 - 7 bar



ANCILLIARY EQUIPMENT

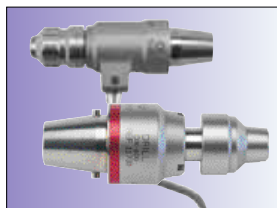

Modular attachments
See page 3 for details.



Sterilisation container.
See page 12 for details.



Wash Assist hose system.
See page 14 for details.

- Modular versatility for universal trauma and procedure specific handpieces for heavy duty orthopaedics.
- High power, high torque co-axial motor unit
- Single handed, instant forward, reverse.
- Fully machine washable.

d

DPX673
Reciprocating saw



DPX-676
Sagittal saw

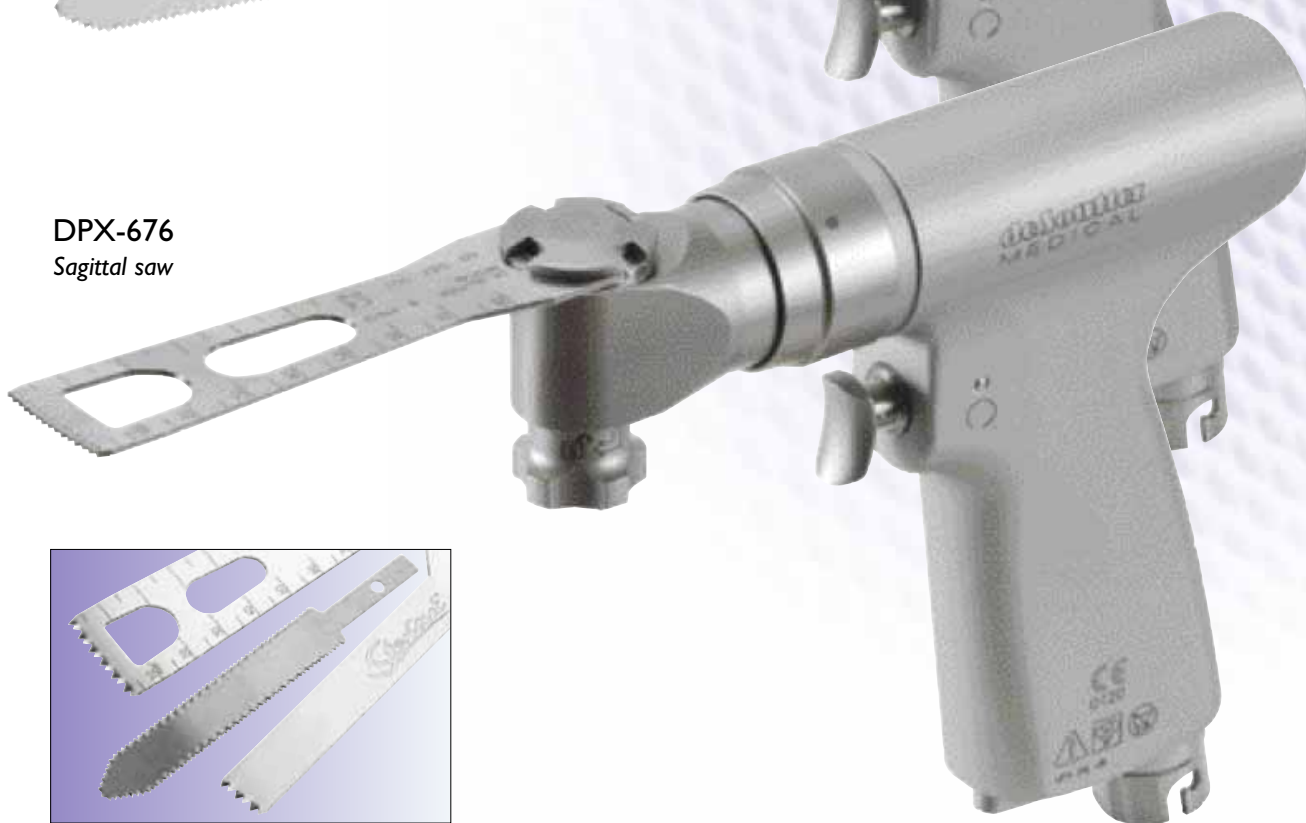

A full range of sterile packed saw blades are available in the De Soutter Medical Stericut™ range. See references below.

HANDPIECE SPECIFICATION

Type	Type code	Order code	Speed	Operating pressure
Sagittal saw	DPX-676	226384	0 - 14000 cycles/min	6 - 7 bar
Reciprocating saw	DPX-673	226394	0 - 11000 cycles/min	6 - 7 bar



See Stericut™ catalogue for range of sagittal and reciprocating saw blades.
See page 12 for details of sterilisation container.

PLX EcoPulse™

Pulsed irrigation system



PLX-620
fitted with
P20-100 pump kit

HANDPIECE SPECIFICATION

Type	Order code	Variable pulse rate	Variable flow rate	Operating pressure
PLX-620	226574	0-1450 pulses/min.	0-0.95 litres/min.	6 - 7 bar

See page 14 for air supply hose options.

- Unique drive coupling designed for De Soutter rotary handpieces, providing maximum O.R. flexibility.
- Optimal power is maintained for longer periods owing to direct drive from the handpiece.
- Smaller packaged volume helps conserve valuable hospital storage - by up to 60%.
- Powerful lavaging performance ensures integrity of the bone/cement interface.
- No need to dispose of entire handpiece, just low cost pump kit, thus reducing costs and clinical waste.

All sterile packed pump kits are supplied 5 per box. All individual nozzles are supplied 5 per box.

PUMP KITS



Pump kits are supplied with pump, nozzle, 3 metres of saline tubing with bag spike and 3 metres of suction tubing.

Type	Order code	Supplied nozzle
General purpose with suction	P20-100	P20-121
Hip arthroplasty with suction	P20-101	P20-121 P20-123
Hip arthroplasty brush with suction	P20-102	P20-124
General purpose without suction	P20-103	P20-120
Hip arthroplasty without suction	P20-104	P20-120 P20-122

NOZZLES - only

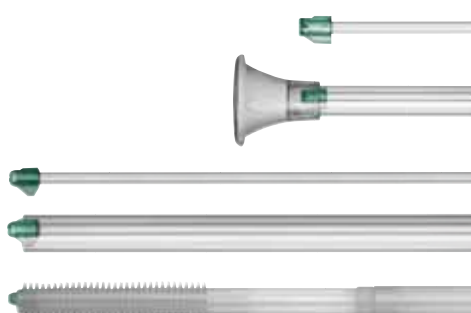

Type	Length	Order Code
Soft tissue without suction	10 cm	P20-120
Soft tissue with suction	10 cm	P20-121
Femoral canal without suction	25 cm	P20-122
Femoral canal with suction	25 cm	P20-123
Femoral brush with suction	25 cm	P20-124

Sterilisation containers

MDX, CDX AND KDX



Sterilisation case for system type	Materials	Complete case Order code	Insert only Order code
Aseptic battery 3 handpieces ¹⁾	Aluminium base, lid and stainless steel insert	12170	12180
Aseptic battery 2 handpieces ²⁾	Aluminium base, lid and stainless steel insert	14440	14450
Sterile battery 3 handpieces ³⁾	Aluminium base, lid and stainless steel	11670	11690

¹⁾ Accommodates MDX-610 handpiece, seven attachments, CDX-600, KDX-600, three aseptic battery housings.

²⁾ Accommodates MDX-610 handpiece, seven attachments, KDX-600, two aseptic battery housings and two sterile shields.

³⁾ Accommodates MDX-610 handpiece, seven attachments, CDX-600, KDX-600 and three sterile battery packs.

MPX



Materials	Complete case Order code	Insert only Order code
¹⁾ Aluminium base, aluminium lid and stainless steel insert	14640	14650
²⁾ Aluminium base, aluminium lid and stainless steel insert	14630	14660

¹⁾ Accommodates one MPX handpiece, one DPX handpiece, seven attachments and air hose.

²⁾ Accommodates one MPX handpiece, two DPX handpieces, seven attachments and air hose.

DPX AND PLX



Materials	Complete case Order code	Insert only Order code	Mat only Order code
Aluminium base, lid and insert	9350	631343	616153







Accommodates air hose and other items in general purpose tray insert.

All sterilisation cases are DIN compatible. Size 538 mm x 254 mm x 142 mm

Accessories

Drive adaptors, reamer shells, drill bits and a

DRIVE ADAPTORS

	Input drive			Output drive
	Hudson Part No.	A.O. Reamer Part No.	A.O. Drill Part No.	
	5440	7970	11550	6.35 mm (1/4") Jacobs chuck
	5450	6590	-	Zimmer chuck
	5460	6550	-	Harris chuck
	-	6560	11580	Hudson chuck
	7910	6580	-	Trinkle chuck
	5470	7980	-	A.O. Synthes quick release drill chuck
	5480	-	-	A.O. Synthes/Protek reamer chuck
	5490	6570	-	DIN58809 reamer chuck
	11260	7770	-	DHS
	-	-	6270	4.0 mm Jacobs Chuck - fits A.O. drill chuck

See Accessory Catalogue publication no. 162 for other drives in the De Soutter Medical range.

ACETABULAR REAMER SHAFT AND SHELLS



A.O. Synthes reamer shaft Part No. 6110
Hudson reamer shaft Part No. 6100



Part No.	Cutting dia mm	Part No.	Cutting dia mm	Part No.	Cutting dia mm	Part No.	Cutting dia mm
5800	40	5880	48	5960	56	6040	64
5810	41	5890	49	5970	57	6050	65
5820	42	5900	50	5980	58	6060	66
5830	43	5910	51	5990	59	6070	67
5840	44	5920	52	6000	60	6080	68
5850	45	5930	53	6010	61	6090	69
5860	46	5940	54	6020	62		
5870	47	5950	55	6030	63		

Fits both standard reamer shaft and minimal invasive reamer attachment.

ir hoses

STERILE PACKED DRILLS

PLAIN SHANK DRILLS



Part No.	Dia. mm	Length mm	Flute length mm
D50-100	1.5	70	22
D50-101	2.0	85	50
D50-102	2.5	95	50
D50-103	2.7	85	50
D50-104	3.2	130	50
D50-105	3.2	180	50
D50-106	3.5	95	50
D50-107	3.5	180	50
D50-108	4.0	156	50
D50-109	4.5	156	50
D50-110	4.5	180	50
D50-111	4.8	127	50
D50-112	5.0	180	50

A.O. DRIVE DRILLS



Part No.	Dia. mm	Length mm	Flute length mm	Part No.	Dia. mm	Length mm	Flute length mm
D55-100	1.1	60	20	D55-108	2.7	125	50
D55-101	1.5	85	30	D55-109	3.2	145	50
D55-102	1.5	110	30	D55-110	3.2	195	50
D55-103	2.0	100	50	D55-111	3.5	110	50
D55-104	2.0	125	50	D55-112	3.5	195	50
D55-105	2.5	110	50	D55-113	4.5	145	50
D55-106	2.5	180	50	D55-114	4.5	195	50
D55-107	2.7	100	50	D55-115	6.0	195	50



'WASH-ASSIST' CO-AXIAL AIR HOSES

The Wash Assist co-axial hose system is recommended where machine washing of air hoses is demanded. By releasing the probe end from hose, which is retained on the hose via the rubber strap, the two hose ends can be joined and sealed prior to machine washing.

Probe	Instrument	3 metre hose - Part no.	4 metre hose - Part No.	5 metre hose - Part No.
	MPX, DPX	13000	13100	13200
	PLX	13600	13700	13800
	MPX, DPX	13010	13110	13210
	PLX	13610	13710	13810
	MPX, DPX	13020	13120	13220
	PLX	13620	13720	13820
	MPX, DPX	13030	13130	13230
	PLX	13630	13730	13830
	MPX, DPX	13040	13140	13240
	PLX	13640	13740	13840
	MPX, DPX	13050	13150	13250
	PLX	13650	13750	13850
	MPX, DPX	13060	13160	13260
	PLX	13660	13760	13860
	MPX, DPX	13080	13180	13280
	PLX	13680	13780	13880
	MPX, DPX	13070	13170	13270
	PLX	13670	13770	13870
	MPX, DPX	13090	13190	13290
	PLX	13690	13790	13890

* Made to special order

Replacement rubber strap Part No. 632393

HANDPIECE WASHING CAPS

Prevents water entering the handpiece during washing prior to autoclaving



Washing cap for standard MPX and DPX series handpieces.

Part No. 608073



Washing cap for PLX series handpieces.

Part No. 8110

167-EN-4

de Soutter
MEDICAL

De Soutter Medical Limited
River Park, Billet Lane, Berkhamsted
Hertfordshire, HP4 1HL. UK
tel: +44 0 1442 860300
fax: +44 0 1442 860333
email: info@de-souttermedical.com
web: www.de-soutter.com

De Soutter Medical Australia Pty Ltd.
2/12-14 Apollo Drive, Hallam
Victoria 3803
tel: 03 9702 4441
fax: 03 9702 4484
email: Australia@de-soutter.com
web: www.de-soutter.com